



HOLLY PRICE POWERED BY **exp** <sup>TM</sup> UK

@ holly.price@exp.uk.com

🌐 hollyprice.exp.uk.com

☎ 01904 373131

## 2, Biba House St. Saviours Place

Offers Over £190,000

🛏️ 1 🚿 1 🚪 1



- Please quote HP0386 when requesting further information or to arrange a viewing
- No Onward Chain
- Ideal City Centre Location
- Well Maintained Communal Areas
- Open Plan Living Dining Kitchen
- High Specification Throughout
- Front Desk Concierge Service





GROUND FLOOR  
331 sq.ft. (30.8 sq.m.) approx.

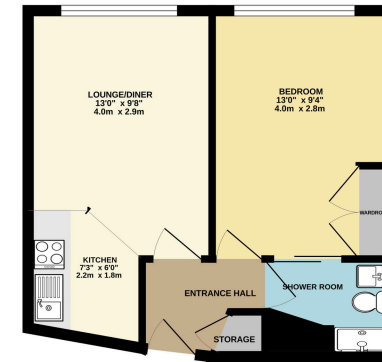

TOTAL FLOOR AREA: 331 sq.ft. (30.8 sq.m.) approx.  
While every effort has been made to ensure the accuracy of the floorplan, measurements of actual rooms, fixtures and fittings may vary slightly from those shown on the floor plan. All dimensions are given in feet and inches. The services, systems and specifications shown have not been tested and are for guidance only. See the separate specification pack for more details.

Experience luxury city living in this stunning one-bedroom ground floor apartment located within the city walls, this exclusive property is one of just 24 apartments, offering an unparalleled standard of living. Finished with a high specification, underfloor heating and front desk concierge service, this is city centre living at it's best. Welcome to Biba House.

Score	Energy rating	Current	Potential
92+	A		
81-91	B		
69-80	C	77 C	77 C
55-68	D		
39-54	E		
21-38	F		
1-20	G		

eXp World UK Ltd is a registered company at Level 37, 25 Canada Square, London, E14 5LQ.

Registered company number is 12016573. VAT Registration Number is 327 4120 29